

## *Karty katalogowe zbiorników*

**Zbiorniki kołowe SOLIDKAN-K**  
**DN1500 wykonanie pierwsze**

[kliknij](#)

**Zbiorniki kołowe SOLIDKAN-K**  
**DN1500 wykonanie drugie**

[kliknij](#)

uwaga:

- powyższe wykonania zbiorników są **zamienne**
  - bieżące wykonania zbiorników w produkcji są zależne od dostępności wymaganych elementów prefabrykowanych
-

## Zbiorniki SOLIDKAN-K

K-1500 - SN

DN1500 - wykonanie pierwsze

K-1500 - SP

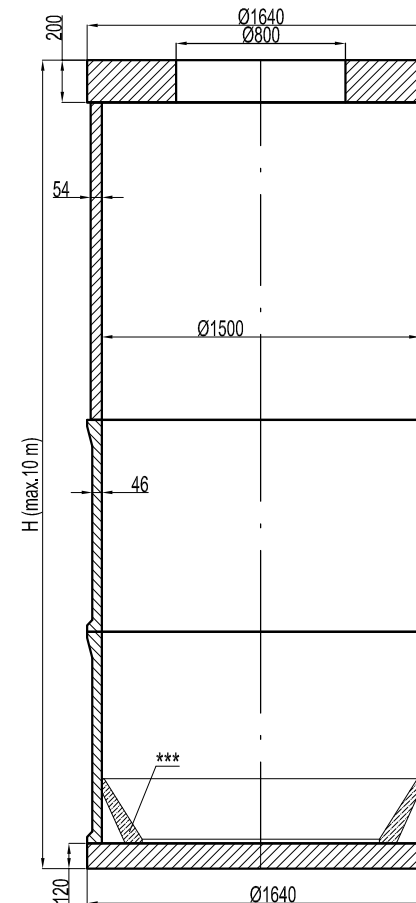
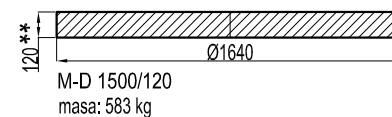
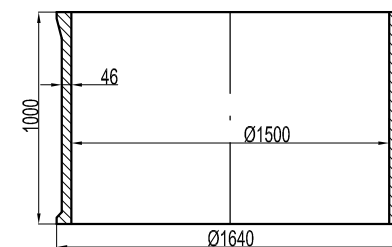
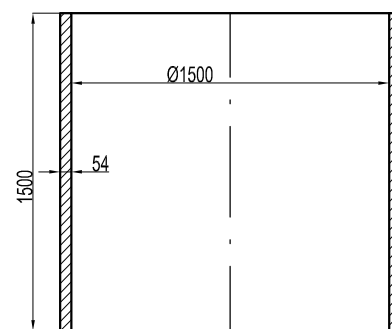
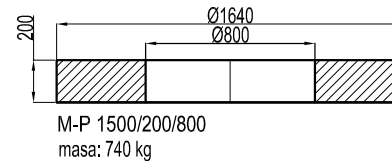
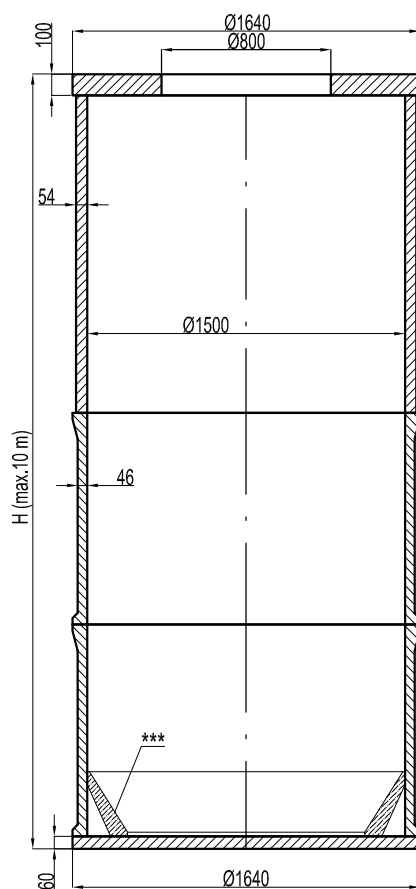
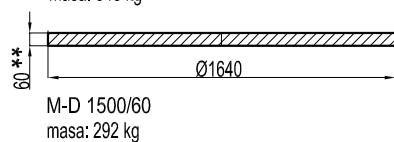
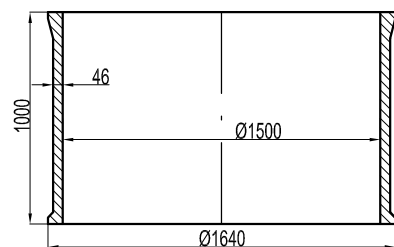
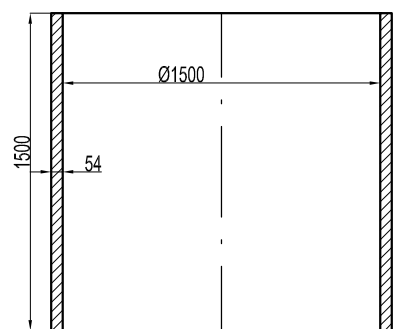
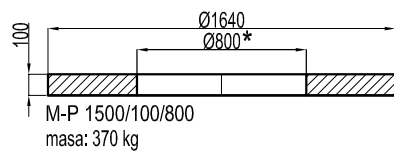

\* inne otwory do uzgodnień

\*\* wysokość minimalna, większa wysokość do uzgodnień

\*\*\* profile denne (opcja doposażenia)

## Zbiorniki SOLIDKAN-K DN1500 - wykonanie drugie

### K-1500 - SN

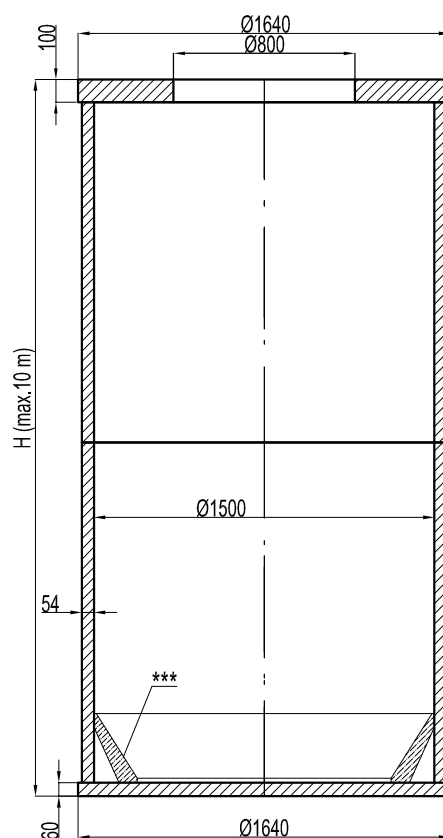
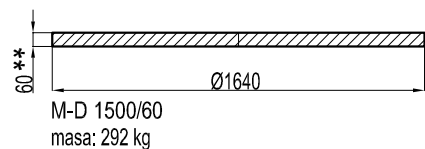
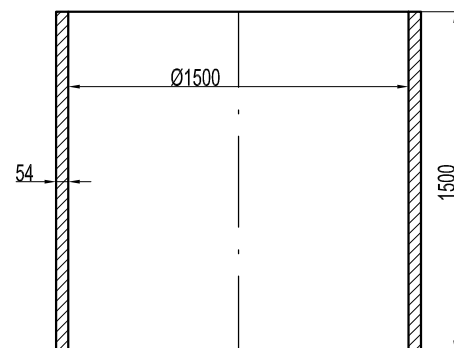
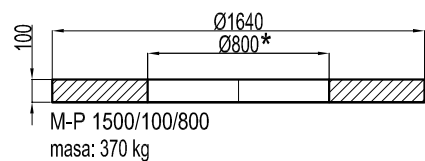

### K-1500 - SP

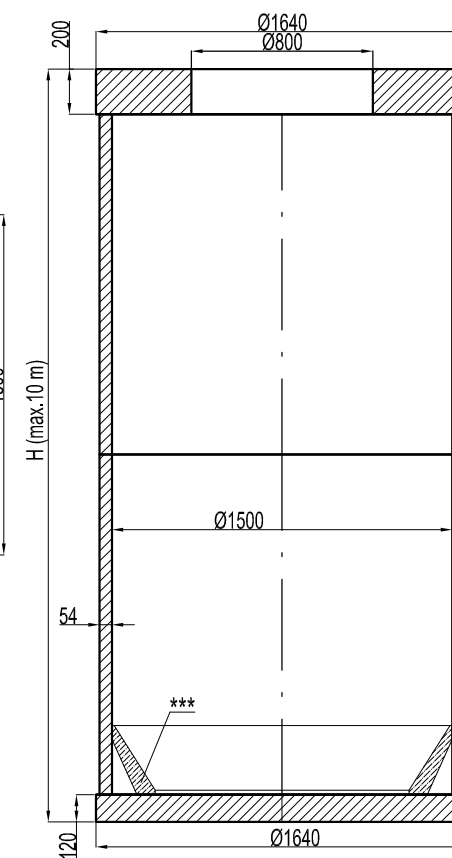
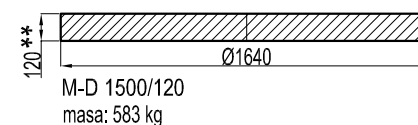
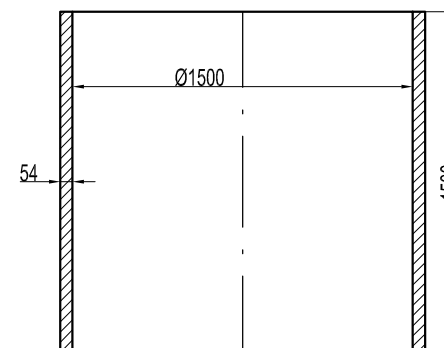
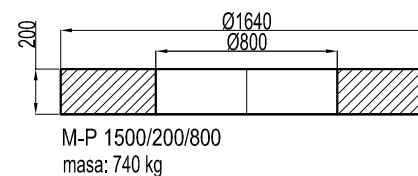

\* inne otwory do uzgodnień

\*\* wysokość minimalna, większa wysokość do uzgodnień

\*\*\* profile denne (opcja doposażenia)